



City of Asotin

www.cityofasotin.org

Phone: 509-243-4411

PO Box 517

121 Cleveland Street

Asotin WA 99402

Fax: 509-243-1223

Required Inspections Post Frame Buildings

- 1. Post Holes:** Before holes are filled or prior to concrete placement.
- 2. Framing:** All framing complete, prior to exterior wall sheathing.
- 3. Final Inspection:** After all work is completed and building is ready to occupy.
(Note it is illegal to occupy without approval from Building Official).
- 4. Please fill in Items 1 through 9 on the application form that apply.**

Building Department Hours: 8:00am – 4:00pm Monday thru Friday

Inspections are available upon request please give at least 48 hours' notice to Building Department Bill Frye at 509-552-0085. Please feel free to leave a message.

If you have Questions about when Inspections are needed please call City of Asotin Building Inspector Bill Frye before you proceed.

Approved Plans must be on Site as well as Building Permit.

City of Asotin Building Inspector
Waste Water Treatment Plant Operator
Bill Frye, CCS1, WDM2
3699 Riverside Dr
Asotin WA 99402
509-552-0085

City of Asotin Building Inspector I
Public Works Superintendent
Bob Portlock
208-791-4663



City of Asotin

www.cityofasotin.org

Phone: 509-243-4411

PO Box 517

121 Cleveland Street

Asotin WA 99402

Fax: 509-243-1223

Permit# _____

City of Asotin Building Permit Application

1. Site Location/Address: _____

2. Parcel#: _____ Block#: _____ Lot#: _____ Addition: _____

3. Owners Name, Address & Phone #: _____

4. Contractor's Name, Address & Phone#: _____

Contractor's License # _____

5. Architect/Designer Name Address & Phone#: _____

Contact Name: _____

6. Engineer Name, Address & Phone#: _____

Contact Name: _____

7. Describe Work: _____

8. Intended Use of Building: _____

9. Valuation of Work: \$ _____

(Planning)

Zone: _____ Lot Size (Actual) _____ Lot Size (Min) _____

Setbacks (Actual) Front _____ Side _____ Rear _____

Setbacks (Minimum) Front _____ Back _____ Rear _____

C.U.P#: _____ Conditions Attached: _____ Variance# _____

Zone Change# _____

Lot# _____ Block# _____ Additions _____ Zoning _____

Approved By _____ Date _____

(Building Area in Square Feet)

1st Floor _____ 2nd Floor _____ Basement _____ Garage _____ Deck _____ Porch _____

Construction Type _____ Occupancy _____ Valuation _____

Permit Fee \$ _____ Plan Fee \$ _____

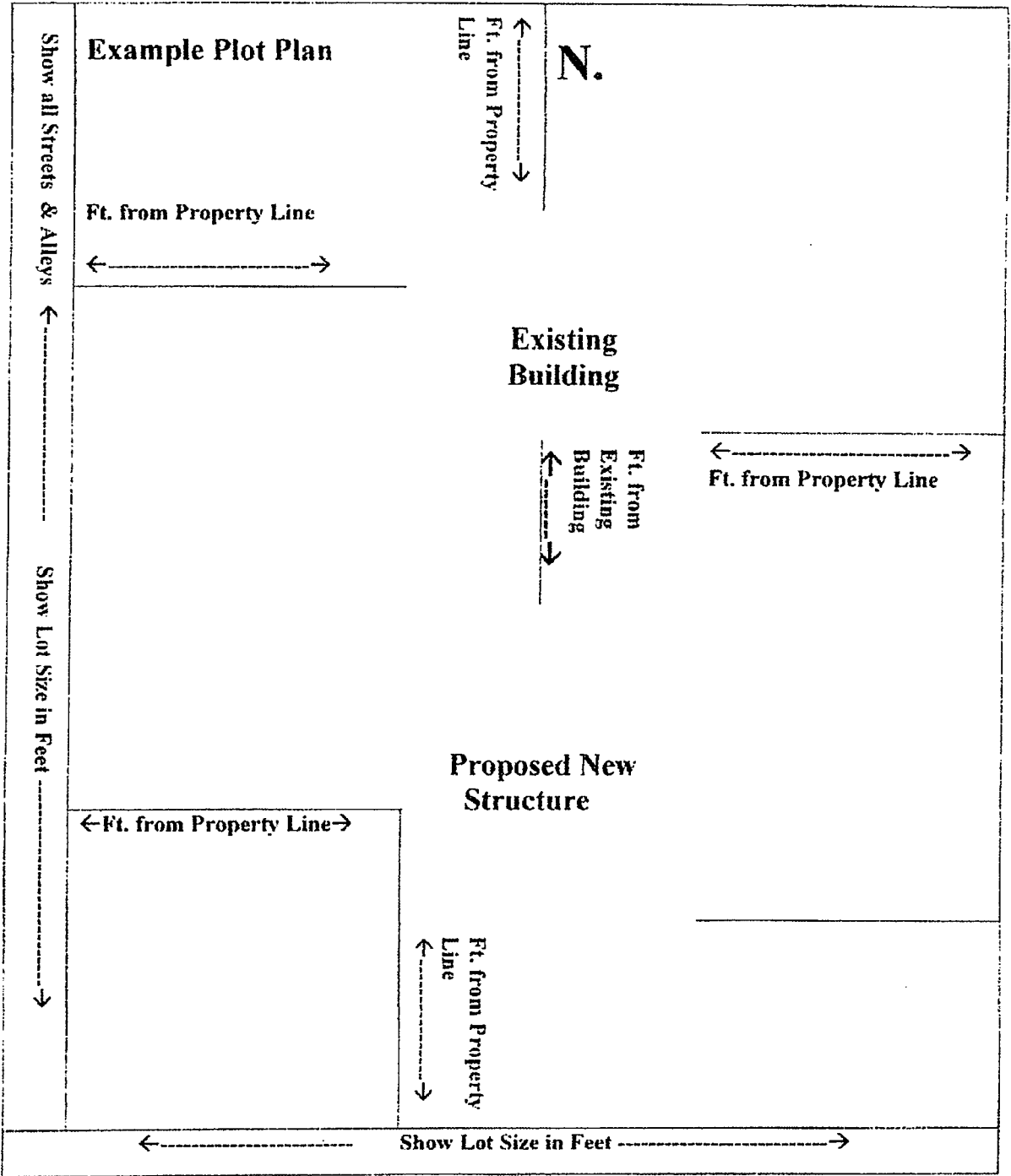



WASHINGTON STATE DEPARTMENT OF REVENUE
LOCAL SALES TAX CHANGE

**Asotin County
Public Safety Tax
Effective April 1, 2020**

Effective April 1, 2020, local sales and use tax within Asotin County will increase three-tenths of one percent (.003). The tax will be used for criminal justice and public safety purposes.

Businesses must collect the appropriate new rate of sales tax for retail sales and services provided within Asotin County. Persons or businesses within Asotin County will be subject to the new rate of use tax on items purchased for their personal or business use if sales tax has not been paid.

The retail sale or use of motor vehicles, and the lease of motor vehicles for up to the first thirty-six months of the lease, **are exempt from the public safety tax imposed**. Please refer to the Asotin County Public Safety Tax Car Dealers and Leasing Companies notice for reporting instructions.

The new rates of sales tax are:

Location	Location Code Number	Local Sales Tax Rate	State Sales Tax Rate	Total Sales Tax Rate
Unincorp. Areas	0200	.015	.065	.080
Asotin (City)	0201	.015	.065	.080
Clarkston	0202	.017	.065	.082

To determine the proper codes and rates of local sales tax you may access our Tax Rate Lookup Tool located at dor.wa.gov. On the home page, click on the **Find a sales or use tax rate** link.

This notice is being sent to businesses that have reported local sales or use tax to any of the above location codes within the last year.

If you have questions, or if Sales Tax Collection Schedules are needed, please go to our web site at dor.wa.gov or call the Department of Revenue at 360-705-6705.

State of Washington
Taxpayer Account Administration
PO Box 47476
Olympia WA 98504-7476

For tax assistance or to request this document in an alternate format, please call 360-705-6705. Teletype (TTY) users may use the Washington Relay Service by calling 711.

REV (1/27/20)