



## City of Asotin

[www.cityofasotin.org](http://www.cityofasotin.org)

Phone: 509-243-4411

PO Box 517

121 Cleveland Street

Asotin WA 99402

Fax: 509-243-1223

### Required Inspections Stick Frame Buildings

- 1. Footing:** Forms and reinforcement in place, prior to concrete placement.
- 2. Foundation:** Forms and reinforcement in place, prior to concrete placement.
- 3. Framing:** All framing complete exterior wall sheathing on but no siding, roof sheathing on, plumbing and electrical installed.
- 4. Insulation:** Framing signed off, insulation in place before sheetrock.
- 5. Sheetrock:** All sheetrock installed before taping.
- 6. Final Inspection:** After all work is completed and building is ready to occupy. (Note: it is illegal to occupy without approval from the Building Official).
- 7. Fill in items: 1 - 9** on the application form that apply.

**Building Department Hours:** 8:00am – 4:00pm Monday thru Friday

**Inspections** are available upon request please give at least 48 hours' notice to Building Department Bill Frye at 509-552-0085. Please feel free to leave a message.

If you have Questions about when Inspections are needed please call City of Asotin Building Inspector Bill Frye at 509-552-0085 before you proceed.

Approved Plans must be on Site as well as Building Permit.

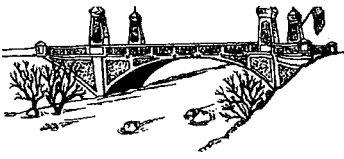

# City of Asotin

[www.cityofasotin.org](http://www.cityofasotin.org)

Phone: 509-243-4411

PO Box 517

121 Cleveland Street

Asotin WA 99402

Fax: 509-243-1223

Permit# \_\_\_\_\_

## City of Asotin Building Permit Application

1. Site Location/Address: \_\_\_\_\_

2. Parcel#: \_\_\_\_\_ Block#: \_\_\_\_\_ Lot#: \_\_\_\_\_ Addition: \_\_\_\_\_

3. Owners Name, Address & Phone #: \_\_\_\_\_

4. Contractor's Name, Address & Phone#: \_\_\_\_\_

Contractor's License # \_\_\_\_\_

5. Architect/Designer Name Address & Phone#: \_\_\_\_\_

Contact Name: \_\_\_\_\_

6. Engineer Name, Address & Phone#: \_\_\_\_\_

Contact Name: \_\_\_\_\_

7. Describe Work: \_\_\_\_\_

8. Intended Use of Building: \_\_\_\_\_

9. Valuation of Work: \$ \_\_\_\_\_

(Planning)

Zone: \_\_\_\_\_ Lot Size (Actual) \_\_\_\_\_ Lot Size (Min) \_\_\_\_\_

Setbacks (Actual) Front \_\_\_\_\_ Side \_\_\_\_\_ Rear \_\_\_\_\_

Setbacks (Minimum) Front \_\_\_\_\_ Back \_\_\_\_\_ Rear \_\_\_\_\_

C.U.P#: \_\_\_\_\_ Conditions Attached: \_\_\_\_\_ Variance# \_\_\_\_\_

Zone Change# \_\_\_\_\_

Lot# \_\_\_\_\_ Block# \_\_\_\_\_ Additions \_\_\_\_\_ Zoning \_\_\_\_\_

Approved By \_\_\_\_\_ Date \_\_\_\_\_

### (Building Area in Square Feet)

1<sup>st</sup> Floor \_\_\_\_\_ 2<sup>nd</sup> Floor \_\_\_\_\_ Basement \_\_\_\_\_ Garage \_\_\_\_\_ Deck \_\_\_\_\_ Porch \_\_\_\_\_

Construction Type \_\_\_\_\_ Occupancy \_\_\_\_\_ Valuation \_\_\_\_\_

Permit Fee \$ \_\_\_\_\_ Plan Fee \$ \_\_\_\_\_

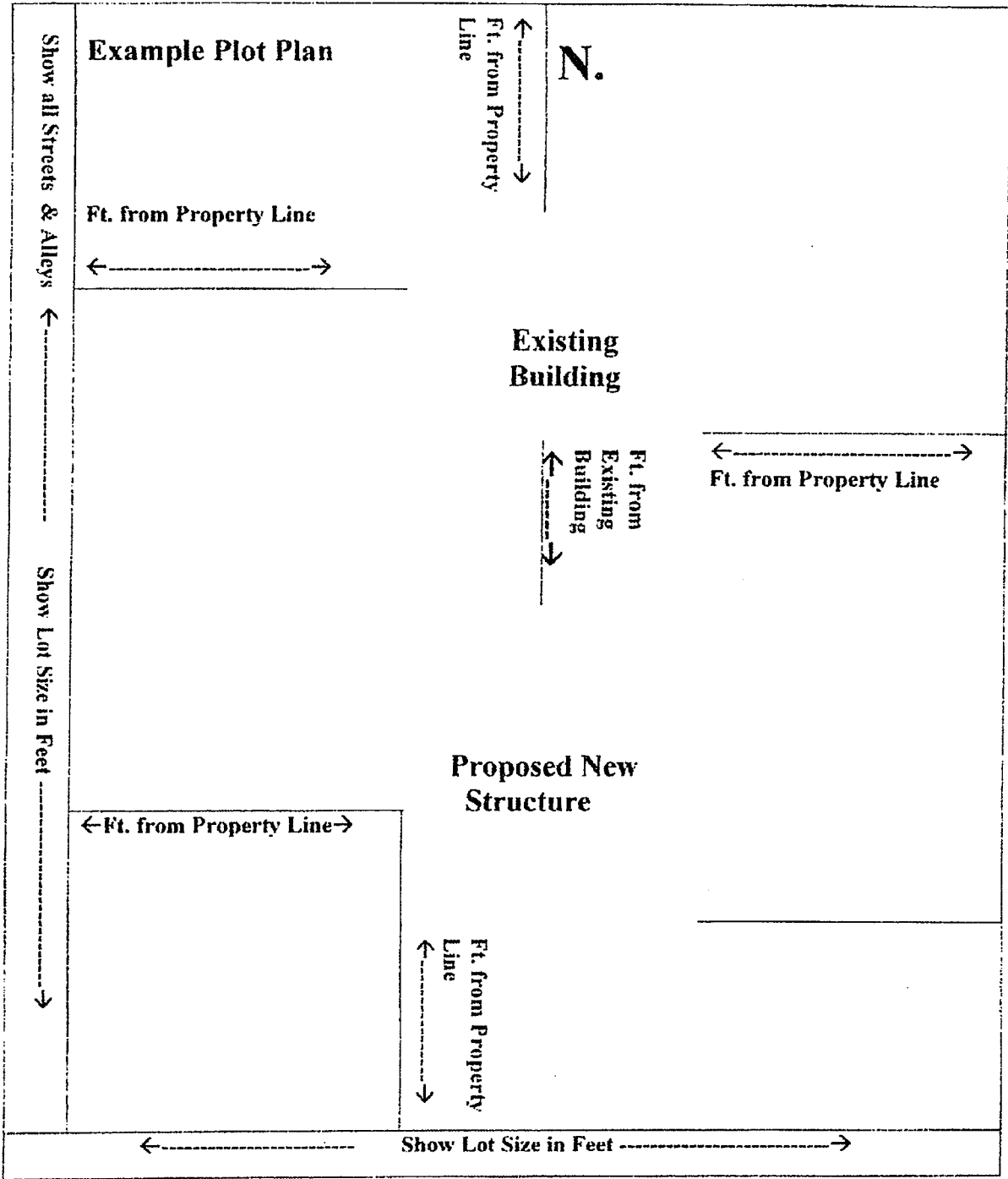



WASHINGTON STATE DEPARTMENT OF REVENUE  
**LOCAL SALES TAX CHANGE**

---

**Asotin County  
Public Safety Tax  
Effective April 1, 2020**

**Effective April 1, 2020**, local sales and use tax within Asotin County will increase three-tenths of one percent (.003). The tax will be used for criminal justice and public safety purposes.

Businesses must collect the appropriate new rate of sales tax for retail sales and services provided within Asotin County. Persons or businesses within Asotin County will be subject to the new rate of use tax on items purchased for their personal or business use if sales tax has not been paid.

The retail sale or use of motor vehicles, and the lease of motor vehicles for up to the first thirty-six months of the lease, **are exempt from the public safety tax imposed**. Please refer to the Asotin County Public Safety Tax Car Dealers and Leasing Companies notice for reporting instructions.

The new rates of sales tax are:

<b>Location</b>	<b>Location Code Number</b>	<b>Local Sales Tax Rate</b>	<b>State Sales Tax Rate</b>	<b>Total Sales Tax Rate</b>
<b>Unincorp. Areas</b>	<b>0200</b>	<b>.015</b>	<b>.065</b>	<b>.080</b>
<b>Asotin (City)</b>	<b>0201</b>	<b>.015</b>	<b>.065</b>	<b>.080</b>
<b>Clarkston</b>	<b>0202</b>	<b>.017</b>	<b>.065</b>	<b>.082</b>

To determine the proper codes and rates of local sales tax you may access our Tax Rate Lookup Tool located at [dor.wa.gov](http://dor.wa.gov). On the home page, click on the **Find a sales or use tax rate** link.

This notice is being sent to businesses that have reported local sales or use tax to any of the above location codes within the last year.

If you have questions, or if Sales Tax Collection Schedules are needed, please go to our web site at [dor.wa.gov](http://dor.wa.gov) or call the Department of Revenue at 360-705-6705.

---

State of Washington  
Taxpayer Account Administration  
PO Box 47476  
Olympia WA 98504-7476

For tax assistance or to request this document in an alternate format, please call 360-705-6705. Teletype (TTY) users may use the Washington Relay Service by calling 711.

REV (1/27/20)