

## City of Asotin

[www.cityofasotin.org](http://www.cityofasotin.org)

Phone: 509-243-4411

PO Box 517

121 Cleveland Street

Asotin WA 99402

Fax: 509-243-1223

### Required Inspections Post Frame Buildings

- 1. Post Holes:** Before holes are filled or prior to concrete placement.
- 2. Framing:** All framing complete, prior to exterior wall sheathing.
- 3. Final Inspection:** After all work is completed and building is ready to occupy.  
(Note it is illegal to occupy without approval from Building Official).
- 4. Please fill in Items 1 through 9 on the application form that apply.**

**Building Department Hours:** 8:00am – 4:00pm Monday thru Friday

**Inspections** are available upon request please give at least 48 hours' notice to Building Department Bill Frye at 509-552-0085. Please feel free to leave a message.

If you have Questions about when Inspections are needed please call City of Asotin Building Inspector Bill Frye before you proceed.

Approved Plans must be on Site as well as Building Permit.

**City of Asotin Building Inspector**  
Waste Water Treatment Plant Operator  
Bill Frye, CCS1, WDM2  
3699 Riverside Dr  
Asotin WA 99402  
509-552-0085

**City of Asotin Building Inspector I**  
Public Works Superintendent  
Bob Portlock  
208-791-4663



# City of Asotin

[www.cityofasotin.org](http://www.cityofasotin.org)

Phone: 509-243-4411

PO Box 517

121 Cleveland Street

Asotin WA 99402

Fax: 509-243-1223

Permit# \_\_\_\_\_

## City of Asotin Building Permit Application

1. Site Location/Address: \_\_\_\_\_

2. Parcel#: \_\_\_\_\_ Block#: \_\_\_\_\_ Lot#: \_\_\_\_\_ Addition: \_\_\_\_\_

3. Owners Name, Address & Phone #: \_\_\_\_\_

4. Contractor's Name, Address & Phone#: \_\_\_\_\_

Contractor's License # \_\_\_\_\_

5. Architect/Designer Name Address & Phone#: \_\_\_\_\_

Contact Name: \_\_\_\_\_

6. Engineer Name, Address & Phone#: \_\_\_\_\_

Contact Name: \_\_\_\_\_

7. Describe Work: \_\_\_\_\_

8. Intended Use of Building: \_\_\_\_\_

9. Valuation of Work: \$ \_\_\_\_\_

(Planning)

Zone: \_\_\_\_\_ Lot Size (Actual) \_\_\_\_\_ Lot Size (Min) \_\_\_\_\_

Setbacks (Actual) Front \_\_\_\_\_ Side \_\_\_\_\_ Rear \_\_\_\_\_

Setbacks (Minimum) Front \_\_\_\_\_ Back \_\_\_\_\_ Rear \_\_\_\_\_

C.U.P#: \_\_\_\_\_ Conditions Attached: \_\_\_\_\_ Variance# \_\_\_\_\_

Zone Change# \_\_\_\_\_

Lot# \_\_\_\_\_ Block# \_\_\_\_\_ Additions \_\_\_\_\_ Zoning \_\_\_\_\_

Approved By \_\_\_\_\_ Date \_\_\_\_\_

### (Building Area in Square Feet)

1<sup>st</sup> Floor \_\_\_\_\_ 2<sup>nd</sup> Floor \_\_\_\_\_ Basement \_\_\_\_\_ Garage \_\_\_\_\_ Deck \_\_\_\_\_ Porch \_\_\_\_\_

Construction Type \_\_\_\_\_ Occupancy \_\_\_\_\_ Valuation \_\_\_\_\_

Permit Fee \$ \_\_\_\_\_ Plan Fee \$ \_\_\_\_\_

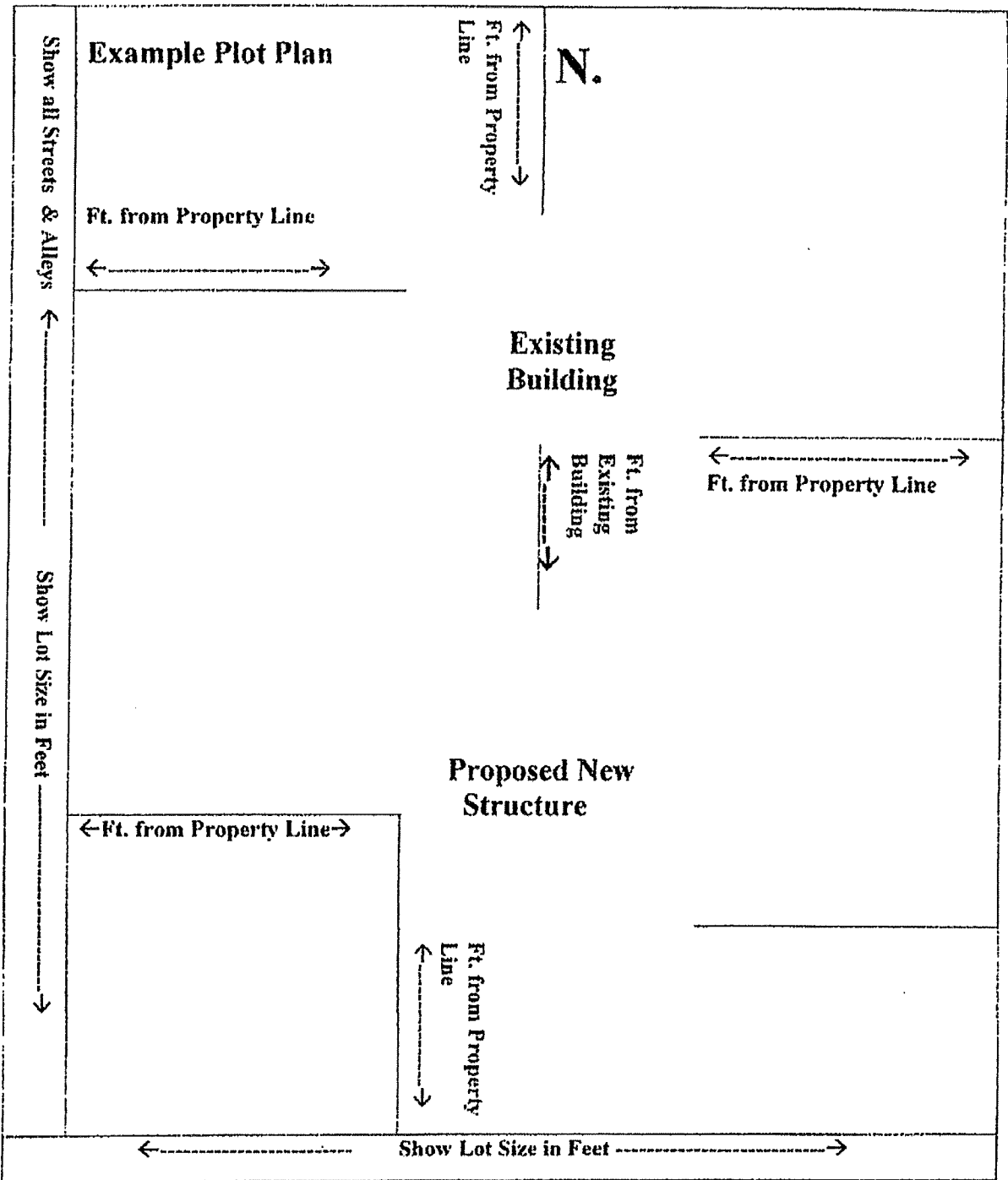

**Asotin County  
Optional Sales Tax  
Effective April 1, 2024**

**Effective April 1, 2024**, sales and use tax within Asotin County will increase two-tenths of one percent (.002). The rate change reflects an increase for the optional sales tax.

Businesses must collect the appropriate new rate of sales tax for retail sales and services provided within Asotin County. Persons or businesses within Asotin County will be subject to the new rate of use tax on items purchased for their personal or business use if sales tax has not been paid.

The new rate of sales tax is:

<b>Location</b>	<b>Location Code</b>	<b>Local Sales Tax Rate</b>	<b>State Sales Tax Rate</b>	<b>Total Sales Tax Rate</b>
<b>Unincorp. Areas</b>	<b>0200</b>	<b>.017</b>	<b>.065</b>	<b>.082</b>
<b>Asotin (City)</b>	<b>0201</b>	<b>.017</b>	<b>.065</b>	<b>.082</b>
<b>Clarkston</b>	<b>0202</b>	<b>.019</b>	<b>.065</b>	<b>.084</b>

To determine the proper codes and rates of local sales tax you may access our Tax Rate Lookup Tool located at [dor.wa.gov/TaxRateLookup](http://dor.wa.gov/TaxRateLookup).

This notice is being sent to businesses that have reported local sales or use tax in Asotin County within the last year.

If you have questions, or if Sales Tax Collection Schedules are needed, please go to our web site at [dor.wa.gov](http://dor.wa.gov) or call the Department of Revenue at 360-705-6705.