



City of Asotin

www.cityofasotin.org

Phone: 509-243-4411

PO Box 517

121 Cleveland Street

Asotin WA 99402

Fax: 509-243-1223

Required Inspections Stick Frame Buildings

1. **Footing:** Forms and reinforcement in place, prior to concrete placement.
2. **Foundation:** Forms and reinforcement in place, prior to concrete placement.
3. **Framing:** All framing complete exterior wall sheathing on but no siding, roof sheathing on, plumbing and electrical installed.
4. **Insulation:** Framing signed off, insulation in place before sheetrock.
5. **Sheetrock:** All sheetrock installed before taping.
6. **Final Inspection:** After all work is completed and building is ready to occupy. (Note: it is illegal to occupy without approval from the Building Official).
7. **Fill in items: 1 - 9** on the application form that apply.

Building Department Hours: 8:00am – 4:00pm Monday thru Friday

Inspections are available upon request please give at least 48 hours' notice to Building Department Bill Frye at 509-552-0085. Please feel free to leave a message.

If you have Questions about when Inspections are needed please call City of Asotin Building Inspector Bill Frye at 509-552-0085 before you proceed.

Approved Plans must be on Site as well as Building Permit.



City of Asotin

www.cityofasotin.org

Phone: 509-243-4411 PO Box 517 121 Cleveland Street Asotin WA 99402 Fax: 509-243-1223

Permit# _____

City of Asotin Building Permit Application

1. Site Location/Address: _____

2. Parcel#: _____ Block#: _____ Lot#: _____ Addition: _____

3. Owners Name, Address & Phone #: _____

4. Contractor's Name, Address & Phone#: _____

Contractor's License # _____

5. Architect/Designer Name Address & Phone#: _____

Contact Name: _____

6. Engineer Name, Address & Phone#: _____

Contact Name: _____

7. Describe Work: _____

8. Intended Use of Building: _____

9. Valuation of Work: \$ _____

(Planning)

Zone: _____ Lot Size (Actual) _____ Lot Size (Min) _____

Setbacks (Actual) Front _____ Side _____ Rear _____

Setbacks (Minimum) Front _____ Back _____ Rear _____

C.U.P#: _____ Conditions Attached: _____ Variance# _____

Zone Change# _____

Lot# _____ Block# _____ Additions _____ Zoning _____

Approved By _____ Date _____

(Building Area in Square Feet)

1st Floor _____ 2nd Floor _____ Basement _____ Garage _____ Deck _____ Porch _____

Construction Type _____ Occupancy _____ Valuation _____

Permit Fee \$ _____ Plan Fee \$ _____

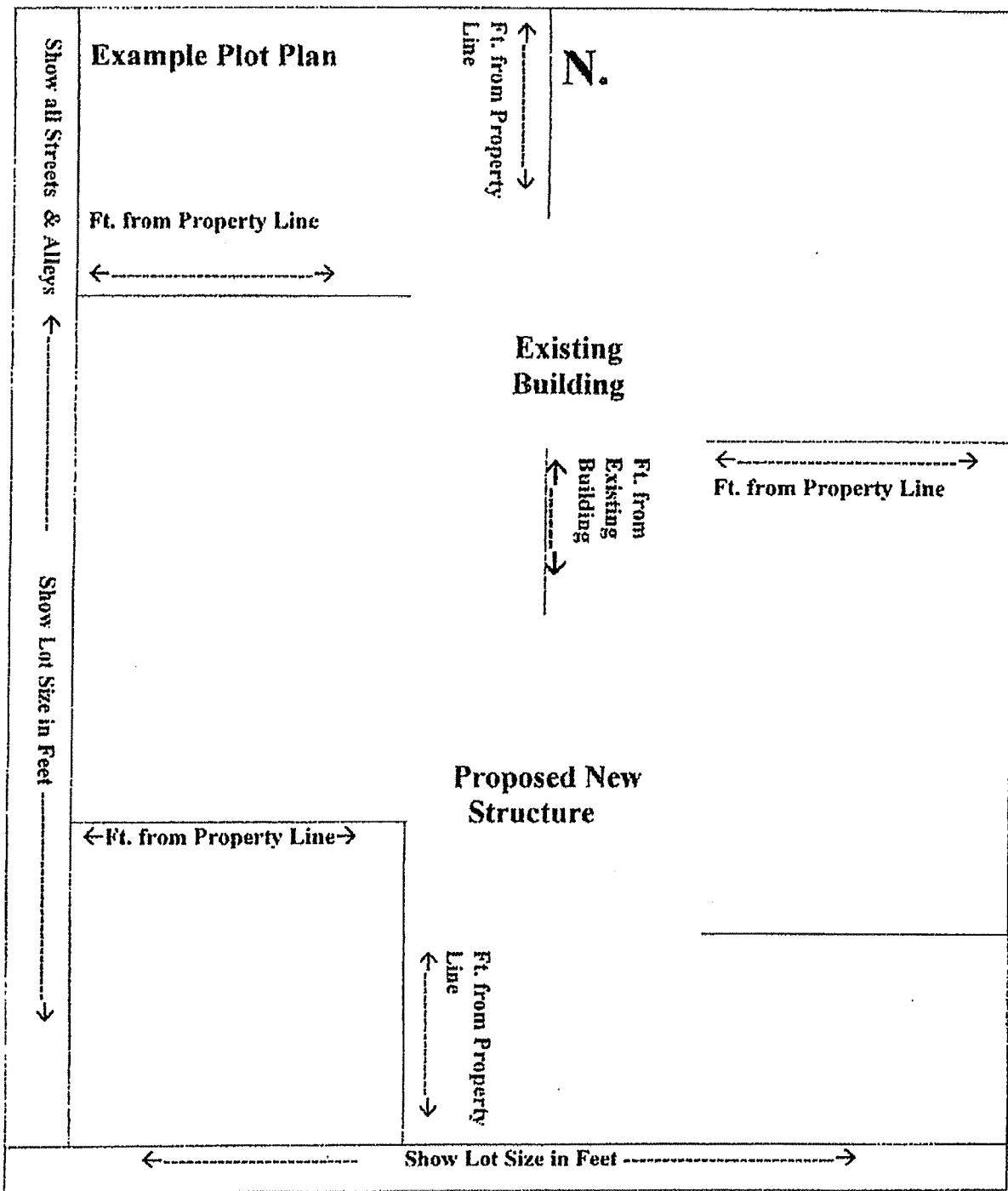

Asotin County
Optional Sales Tax
Effective April 1, 2024

Effective April 1, 2024, sales and use tax within Asotin County will increase two-tenths of one percent (.002). The rate change reflects an increase for the optional sales tax.

Businesses must collect the appropriate new rate of sales tax for retail sales and services provided within Asotin County. Persons or businesses within Asotin County will be subject to the new rate of use tax on items purchased for their personal or business use if sales tax has not been paid.

The new rate of sales tax is:

Location	Location Code	Local Sales Tax Rate	State Sales Tax Rate	Total Sales Tax Rate
Unincorp. Areas	0200	.017	.065	.082
Asotin (City)	0201	.017	.065	.082
Clarkston	0202	.019	.065	.084

To determine the proper codes and rates of local sales tax you may access our Tax Rate Lookup Tool located at dor.wa.gov/TaxRateLookup.

This notice is being sent to businesses that have reported local sales or use tax in Asotin County within the last year.

If you have questions, or if Sales Tax Collection Schedules are needed, please go to our web site at dor.wa.gov or call the Department of Revenue at 360-705-6705.